



P880-G45-BZ
2-7/16 [61] Wide 45-Degree Bronze Grate

Dimensional Data (inches and [mm]) are Subject to Manufacturing Tolerances and Change Without Notice

[Back to Index](#)

Please Check	Item No.	Part Number	Item I.D.
✓	4	94054-001	P880-G45-BZ

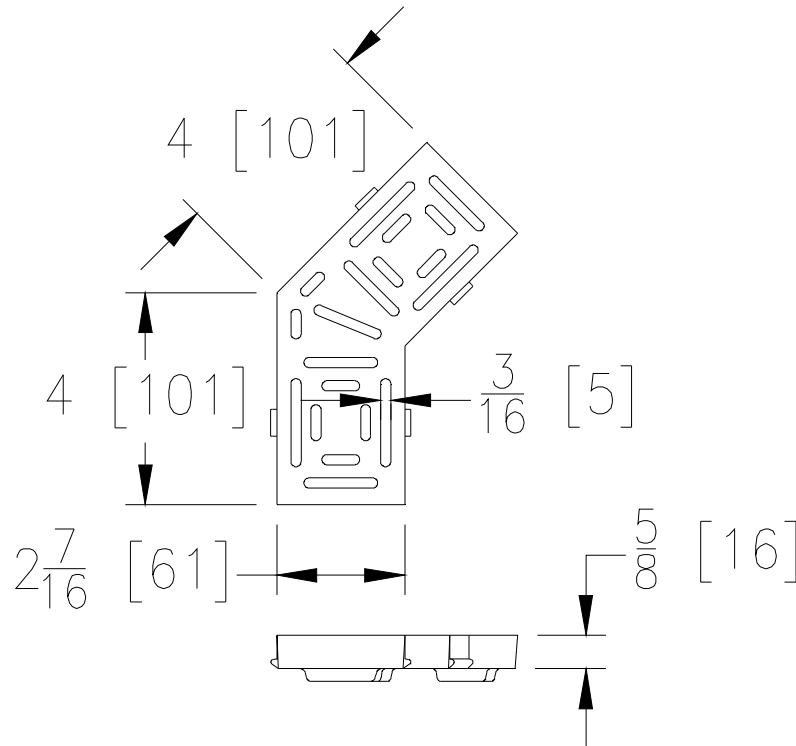

G45-BZ GRATE ENGINEERING SPECIFICATION: The Zurn P880-G45-BZ

45-Degree Bronze Grate, is 2-7/16 inches wide, weighing .50 lbs per linear foot. The grate has an open area of 5.28 square inches per linear foot, DIN Rating of Class A, ANSI Rating of Light-Duty and is ADA Compliant.

G45-BZ - 45-Degree Bronze Grate	
Material:	Bronze
DIN Rating:	Class A
Weight:	.50 lbs/ft.
Open Area:	5.28 in ² /ft.
ANSI Rating:	Light-Duty
Application:	Decorative Heel-Proof
Slot Width/Hole Size:	3/16"
ADA:	Yes
H-20:	No
FAA:	No